



# Liberty County Property Record Card

2024 Digest

<b>PIN#: 046B114</b>	<b>Date: 11-25-2024</b>	<b>Page: 1</b>
<b>Owner Information</b>	<b>General Information</b>	<b>Values</b>
<b>EDWARDS COREY E</b>	Physical Address: 642 FLEMING RD	Improvements: 120,055
642 FLEMING RD	Property Description:	Accessories: 288
	LOT 116 MARY L CAINES S/D	Land: 30,000
	Tax District: HINESVILLE	<b>Total: 150,343</b>
	Homestead: <b>NONE</b>	Previous: 131,769
HINESVILLE, GA 31313	Total Acres: .00	2022: 79,656
	Zoning: R12	2021: 79,656
	GMD: 1458	2020: 79,656
<b>REALKEY: 10775</b>	OLD PIN: H18 166	

Sales Info:							
Grantee:	Grantor:	Date:	Deed Book:	Plat Book:	Sale Price:	CS:	Reason:
EDWARDS COREY E	OWNEZ ASSET MANAGEMENT LLC	2022-05-20 00:00:	2233 840	5 64	162,000	R3	OF
OWNEZ ASSET MANAGEMENT LLC AN INDIANA L	AVILA LEO SAUL E & SANCHEZ-PINEIRO HILDA	2022-05-20 00:00:	2232 566	5 64	135,000	R1	FM
AVILA LEO SAUL E & SANCHEZ-PINEIRO HILDA	ROGERS MALINDA	2017-09-29 00:00:	1965 748	5 64	77,500	R3	FM
ROGERS MALINDA		1988-12-30 00:00:	474 327		0	R1	GD

Land Influences:						
Topography: 1.00	Corner: 1.00	View: 1.00	Water: 1.00	Transitional: 1.00	Neighborhood: 1.00	Other: 1.00

Land Info:											
CS:	SubRecord:	Code/Description:	Method:	Unit:	Depth:	From Front:	Ave Depth:	Depth Factor:	Unit Value:	Adjustment:	Value:
R3	1	5325/MARY L CAINES	LOT	1	0	0	200	0	30,000.00	1.00	30,000

Accessory Improvements:													
Key:	CS:	Description:	Size:	Units:	Year:	Grade:	Depr Front:	OvrD:	PCom:	Func:	Neigh:	ID Units:	Cal/Ovr Val:
128171	R9	Solid Waste	0X0	1	2003			1.00	1.00	1.00	1.00	0	
178459	R1	Utility Bldg/Shed	10X12	0	2006	1.00	.24	.00	1.00	1.00	1.00	0	288



# Liberty County Property Record Card

2024 Digest

PIN#: 046B114

Date: 11-25-2024

Page: 2

### Residential Improvements:

Impr Key: 4448	Class/Strat: R1	Occupancy Style: One Family	Rooms: 10	Bedrooms: 3
Heated Area: 1,044	Story Height: 1.0 Story	Foundation: Masonry	Attic/Finish: No Attic	Basement/Finish: None None
Attic Area/% Finish: 0/.00	Basement Area/% Finish: 0/.00	Attic Quality:	Basement Quality:	Exterior Wall: Wood
Roofing: Asphalt Shingles	Roof Shape: Gable	Floor Construction: Wood Joist	Floor Finish: Carpet	Interior Wall:
Interior Ceiling: Sheetrock	Heat: Central Heat/AC	Std Comp: 1	Extra Fix: 3	Full Baths: 2
Half Baths: 0	Grade: 1.00	Year Built: 1976	Eff Year Built: 2006	Condition: Good
Replacement Cost New: 126,908	Physical Depreciation: .86	Physical OVR: .00	Func Obsol: 1.00	Econ Obsol: 1.00
% Complete: 1.00	Neigh Adj:	CD: 1.00	FMV: 120,055	OVR FMV: 0

### Sketch Legend:

Type:	Area:
1st	1044
OP	60
CP	264

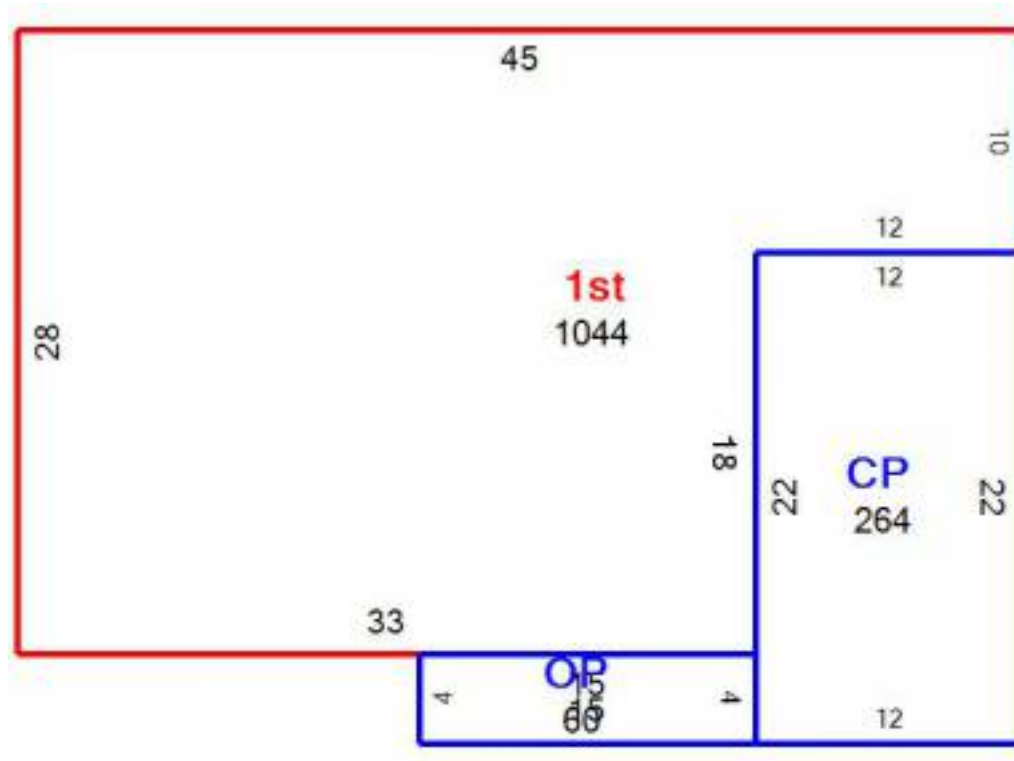

PIN#: 046B114

Date: 11-25-2024

Page: 3

FRONT:



PIN#: 046B114

Date: 11-25-2024

Page: 4

A178459

